

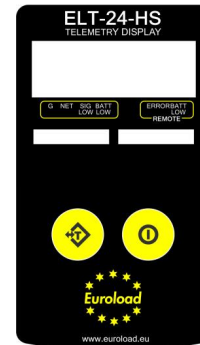

## ELT-ECO24 Economic Telemetry Load Shackles



Design range 4.75 to 17 tonne. Van Beest G-4163

This range of load shackles has been designed to give a very economically priced, high accuracy, high function solution for load monitoring using small shackles.

T-24 new long-range telemetry transmitter and receiver handset. Optional: handset to read multiple shackles and give total, data logging up to 100 shackles in one area. Contact us for the full capability of the new T-24 range of electronics.

Standard features: 2 x AA bat powered transmitter, long battery life up to 5 years, remote power down, up to 200 updates per second, IP67 ingress protection, minimum 5:1 factor of safety, fully stainless steel load pin, down hole strain gauged, dielectric gel filled, protective load bobbin (highly recommended), supplied c/w Van Beest G-4163 bow.

Sizes available from stock, 4.75, 6.5, 8.5, 9.5, 12, 13.5 and 17 tonne.

Available in our Aberdeen office or local distributor.



## ELT24-HS

# Wireless Handheld Display For Single Transmitter

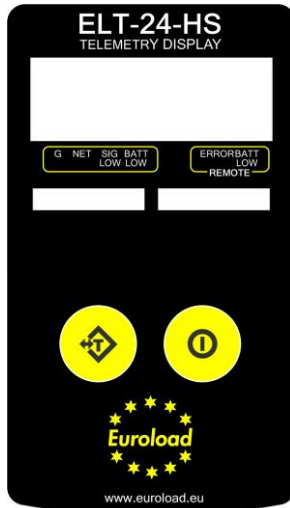

### Product Features

- Simple operation
- Connection to single transmitter module
- Tare function
- Auto shutdown
- Rugged construction

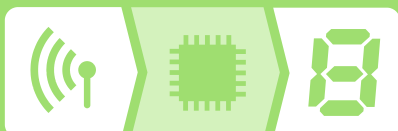

### Introduction

The T24-HS handheld displays data from any of the T24 wireless transmitter modules and forms part of the T24 modular telemetry system.

The data sent by transmitter modules can be utilised by multiple receivers such as displays, handheld readers, analogue outputs, relay modules and computer interfaces. Receivers support common industrial power supplies and are available in robust IP rated enclosures with internal antennas optimised to give outstanding coverage.

The T24-HS provides a point to point connection to a single transmitter. The transmitter can be woken and sent to sleep as the handheld is turned on or off. Two AA batteries power the handheld which has been designed for low power operation.

The T24 Toolkit software offers a fast and simple way to configure the display format, unit conversion, zero adjustment and transmitter selection.

### T24 System Overview



T24 Wireless Telemetry Sensor System is a modular wireless solution for industrial sensor applications.

High accuracy, high quality measurement is interfaced with simple yet powerful configuration and monitoring software.

WWL	A	B	C	D	E	F	G	H	I	J	K	KGS	Bobbin dia	M
4.75	19	22	46	19	31	76	51	129	114	89	19	1.18	38	45
6.5	22	25	52	22	36	83	58	144	130	102	22	1.77	42	45
8.5	25	28	59	25	43	95	68	164	150	118	25	2.58	52	45
9.5	28	32	66	28	47	108	75	185	166	131	27	3.66	60	45
12	32	35	72	32	51	115	83	201	178	147	30	4.91	64	45
13.5	35	38	80	35	57	133	92	227	197	162	33	6.54	68	45
17	38	42	88	38	60	146	99	249	202	175	19	8.19	82	45

All Sizes in MM

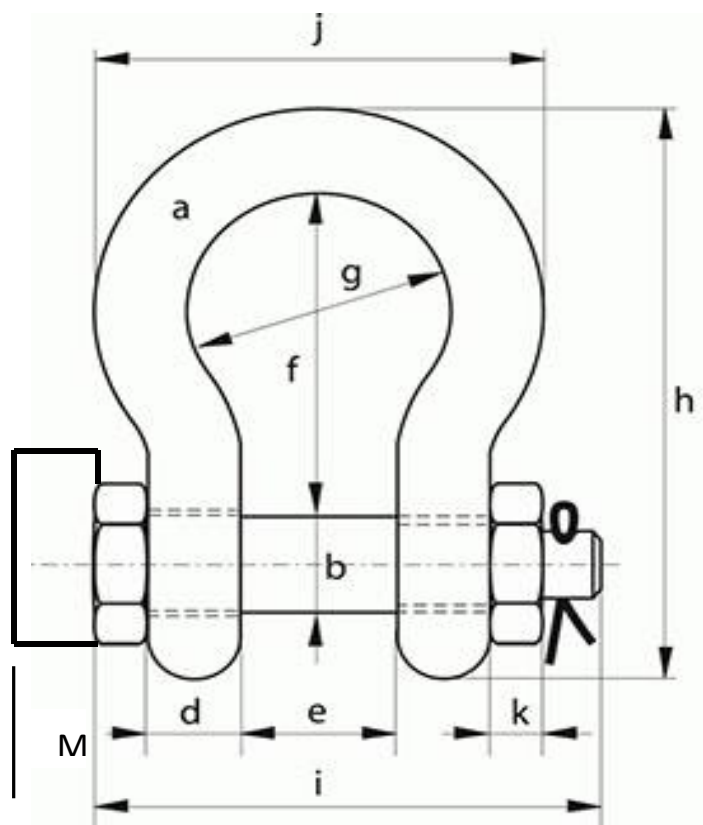

## Green Pin Standard Shackles. Pt no G-4163

**Material:** Bow high tensile steel. Pin: Stainless steel 17-4.

**Safety Factor:** MBL equals 5 x WLL

**Standard:** EN13889

**Finish:** Hot dipped galvanized

**Output:** ELT24 telemetry output. Power 2 off AA batteries.

**Receiver handset:** ELT24-HS.

All ELT 24 receivers, gateways, large displays, data loggers work with the ECO shackles.

